



These installation instructions are of a general nature and designed to assist suitably experienced tradesmen to install Autex Cube™ to a high standard in common wall and ceiling installations.

For installation support, contact your Autex Account Manager before you start.

Manufacturer's Documents

Autex recommends that all persons engaged in installing Cube™ have full knowledge of the product and installation procedure as set out in the most recent edition of the manufacturer's instructions and related documents.

Manufacturer's documents relating to work in this section are:

- Autex Cube™ Datasheet
- Autex Cube™ Manufacturers Guarantee
- Autex Cube™ Install Instructions

Copies of the above literature are available on request or from the Autex website.

Devices generating heat

Localised high temperature conditions may be present in the following situations which may be detrimental to wall and ceiling linings:

Including, but not limited to:

- Radiant heaters
- Lighting
- Heat pumps
- Reverse cycle air conditioners
- Solid fuel stoves

For more information, refer to the current documents below:

- NCC provisions for installation of heating appliances, fireplaces, chimneys and flues
- AS 2918 Domestic solid-fuel burning appliances — Installation
- AS 5601 Gas installations
- AS/NZS 3000:
- Unit manufacturer installation instructions

All appliances including lamps, luminaires and their associated ancillary gear should be installed so as not to cause the Cube™ surface temperature to rise above 176°F.

Inspection

Before starting the installation of Autex Cube, check again that the materials have been supplied as ordered and are free from damage or faults. Check colours and product labels to ensure the product has been supplied correctly.

Where multiple sheets of Cube are required, it is important to check that all product is supplied from one batch. Due to batch to batch variation, we do not recommend joining different batch lots as this could result in colour variation.

For best results, ensure Cube panels are applied with the same side facing throughout the job. Look for the label 'This side to the wall' for easier identification.

Any variations must be reported to Autex prior to commencing the installation. No claims will be accepted where the job continues with obvious faults, and no consultation with Autex has taken place.



Transportation, Storage & Handling

Cube must be transported, stored and handled with care. Cube should be kept dry and stored indoors. Avoid delamination or distortion and protect edges from being crushed.

Do not accept damaged product. If the product arrives damaged note the condition on the freight

documents and contact Autex immediately. Goods signed as received in 'good condition' will not be the responsibility of Autex.

Always transport and store Cube on a flat, clean and dry surface.

On-site Panel Care

Cube panels are a semi rigid product that can be damaged if not handled with care. Avoid bending the packs and panels as this could cause creasing. Do not store or drop the panels on their corners or edges as this will cause damage. Clean cloth gloves are ideal when handling Cube to avoid soiling.

Recommended Adhesive

Autex recommends a contact-type adhesive or full curing panel adhesive for applying Cube to most common substrates. Prior to commencing work, we recommend contacting your local adhesive supplier with samples of the Autex products you are installing and the specification of the substrates you are installing to.

It is the installer's responsibility to ensure that any adhesive is fit for the intended purpose. It also is the installer's responsibility to ensure that the substrate is fit for the application of adhesives and Autex wallcoverings. For information regarding adhesive suppliers, please contact your Autex Account Manager.

Substrate

Before work commences, all joins, gaps and cracks in the wall/ceiling substrate must be taped with propriety sealing tapes to eliminate the ingress of dust and foreign particles travelling from the cavity into the installed product over time. Ensure that the substrates, backgrounds and adjoining surfaces will allow work to reach the required standard.

Autex recommends that the wall/ceiling surfaces be prepared to a minimum Level 3 finish.

Very porous surfaces may need to be sealed prior to applying the adhesive. Gloss and semi-gloss finishes should be lightly sanded and dusted clean prior to application of the adhesive.

All surfaces must be clean, dust-free and dry as dust and moisture will adversely affect the adhesive and may result in lack of adhesion.

Install Cube General

Autex Cube should always be installed in accordance with these installation instructions and as per the specification detail and customer requirements. If there is conflicting information, you must seek clarification from all appropriate parties before proceeding with the work. It is imperative that the installation is planned before cutting and installing any product. Autex Cube panels are supplied at the dimensions stated on your local datasheet. We recommend working within dimensions that allow trimming to size. Cube factory edges are not always 100% square so trimming, squaring or chamfering of the panel edges may be required. Always do a 'dry fit' first before gluing to ensure there are no undue gaps in panel joins or at junction points.

We recommend you "measure twice and cut once".

Adhesives should be applied strictly in accordance with the adhesive manufacturer's instructions. Refer to the product label or the technical datasheet for spread rates, tack-off times, application methods and equipment required.

Adhesive spills or surface contamination should be cleaned immediately ensuring fabric care instructions on the Cube Datasheet are followed.

The job should be progressively checked for appearance, installation quality and adequate adhesion. Any variations in colour or appearance must be notified and discussed with your Autex Account Manager. No claims will be accepted where the job continues with obvious faults, and no consultation with Autex has taken place.



Install Cube Walls

Autex Cube should be installed to a clean, flat wall substrate that is prepared in accordance with the recommendations listed above.

Cube Panels come with a sticker on the side that needs to be installed to the wall. The label also reminds you that there is a protective spun bond layer that needs to be removed before installation. The arrow ensures all panels are installed in the same direction to prevent any perceived colour variation when installing panels side by side.

For ease of installation, we recommend that you install each Cube panel individually. This includes the application of adhesive and rolling the panel.

Apply the adhesive to the Cube panel and substrate as measured for the Cube panel, ensuring the adhesive manufacturer's instructions are followed correctly.

Extra adhesive can be applied to the wall along butt-joints to ensure adequate adhesion and a tight joint. Care should be taken not to apply excessive adhesive along joints as this can leak at the seams when pressure is applied.

Ensure the adhesive has tacked-off correctly then fit the Cube panel to the wall. Where joining Cube™ panels with a butt-joint it is recommended the panel is fitted firmly to the join first, then smoothed out to the edges applying even pressure to ensure adequate adhesive transfer and a strong bond.

Finally, roll the Cube panels towards the butt-joints, then roll the entire Cube™ panel to ensure adhesive transfer and a strong bond. Small wallpaper and vinyl rollers must not be used. A wide roller approximately 4" - 5" is ideal.

Continue as above for all panels until complete.

Install Cube Ceilings

Autex Cube can be installed to a flat ceiling substrate or direct fixed to battens.

When Autex Cube panels are installed overhead, a combination of adhesive and mechanical fixings is recommended. Fixings must take into studs, battens or a solid substrate a minimum 1"

and where there is no chance of threading or pulling out. These guidelines assume the use of screws.

Note: When mechanical fastenings/screws are not desired consultation with your adhesive supplier is recommended to ensure the panel will be permanently bonded to the substrate.

Fix to Ceiling Substrate

Autex Cube should be installed to a clean, flat ceiling substrate that is prepared in accordance with the recommendations listed above. For ease of installation, we recommend that you install each Cube panel individually. This includes the application of a suitable high-quality adhesive (contact your local Autex Account Manager for suitable options), screw fixing and rolling the panel.

Apply the adhesive to Cube panel, and the substrate as measured for the Cube panel, ensuring the adhesive manufacturer's instructions are followed correctly. We recommend the additional use of a suitable adhesive around the perimeter and through the length of the Cube panels at the nominated centers to help ensure a strong bond.

To ensure a tidy and flat installation, additional battens may be required, refer to 'Fix to Ceiling Battens' section.

Care should be taken not to apply excessive adhesive along joints as this can leak at the seams when pressure is applied. Ensure the adhesive has tacked-off correctly then fit the Cube panel to the ceiling. When joining Cube panels with a butt-joint, it is recommended the panels are fitted firmly to the join first, then smoothed out to the edges applying even pressure to ensure adequate adhesive transfer and a strong bond.

Screw fixings are also recommended to secure the Cube panels to ceilings. Where a combination of adhesive and screw fixings is being used screw fixings can be set at up to 24" centres in all directions. Avoid over-tightening the screws as this may pinch the Cube material.

Finally, roll the Cube panels towards the butt-joints, then roll the entire Cube panel to ensure adequate adhesive transfer and a strong bond. Small wallpaper and vinyl rollers must not be used. A wide roller approximately 4" - 5" is ideal. Continue as above for all panels until complete.

Cube fixed to ceiling substrate

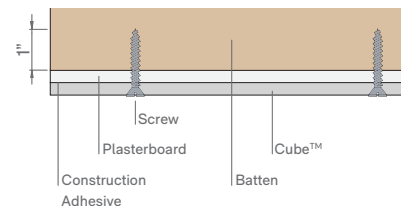



Fix to Ceiling Battens

To ensure a tidy and flat installation, make sure the batten surfaces are flat and flush as Cube panels will show any undulation caused by mismatched joints or protruding fixings.

Battens should be 1 3/4" minimum width and centres should be set at 16" to reduce the potential of the Cube panels pillowing or sagging. A suitable adhesive must be applied along the length of the batten prior to screw fixing. Where panels butt, allow a minimum 1 3/4" fixing area for each edge of the Cube panel to ensure the edges can be securely fixed. This may require double-battening. The screw thread must take at least 1" purchase into battens. Avoid over-tightening the screws as this may pinch the material.

Fixing position should be maximum 16" centres around the perimeter and through each panel. We recommend fastening Cube panels from one side to the other to help avoid pillowing and sagging through the middle of the panel.

Cube fixed to ceiling battens

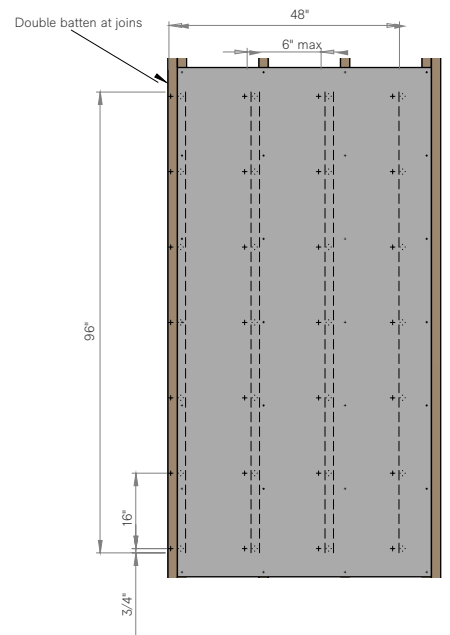
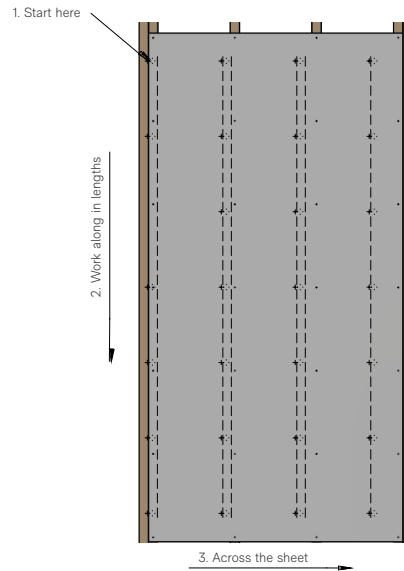
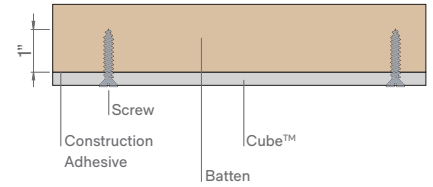

Cutting Cube

When cutting Autex Cube, use a circular saw with a narrow blade with a minimum of 80 teeth. This will ensure a smooth cut. You may want to duct tape the saw's shoe so that it doesn't scratch up the surface as you cut. Alternatively Cube can be cut with a steady hand and a sharp utility knife. Lay Cube face-side down and cut from the back to the front.

Mark off the line you want to cut using masking tape. Alternatively, you can use a reverse toothed high carbon steel jigsaw blade with ground teeth which cuts down rather than up, so top surface maintains its finish. This is also the best option for making curved cuts.

Fixtures

Remove cover plates, light fittings and other fixtures as the work proceeds. Replace, plumb, square and true to line as the work is completed.

Note: All electrical plumbing, fire safety appliances and fittings should only be removed and re installed by an appropriately qualified person.



Penetrations

The fire and acoustic performance of walls and ceilings can be reduced by penetrations for plumbing, electrical switches, light fittings etc. For wall or ceilings that require a Fire resistance level (FRL) and or are acoustically sensitive, it is recommended that, wherever possible, such penetrations are avoided. Where penetrations are necessary only appropriately rated proprietary sealants and fittings should be used.

If unsure, we recommend consultation appropriately qualified person is undertaken to ensure the buildings performance objectives are maintained.

Replace

Replace damaged or marked elements.

On Completion

Leave work secure, smooth and free of air bubbles, wrinkles, gaps, stains and blemishes and to the standard required by following procedures. Clean adjoining surfaces of any adhesive. Remove debris, unused materials and waste from site.

Service

For more information, contact your Autex Account Manager or visit our website www.autexglobal.com

● Autex Industries Ltd

702-718 Rosebank Rd
Private Bag 19988
Avondale 1746, Auckland
New Zealand
Freephone 0800 428 839
Phone +64 9 828 9179
Fax +64 9 828 5810

● Autex Australia Pty Ltd

166 Bamfield Road
PO Box 5099
West Heidelberg, Melbourne
VIC 3081, Australia
Freephone 1800 678 160
Phone +61 3 9457 6700
Fax +61 3 9457 1020

● Autex Acoustics Ltd

Unit J4, Lowfields Way,
Lowfields Business Park,
Elland, West Yorkshire
Hx5 9Da
United Kingdom
Phone +44 0 1422418899

● Autex Acoustics LLC

1630 Dan Kipper Dr,
Riverside, CA 92507
United States of America
Phone +1 424 203 1813

An ISO 9001, ISO 14001 and ISO 45001 certified company. The brand names and logos mentioned herein are registered or unregistered trademarks either owned or used under license by Autex Industries Limited or other members of the Autex Group. The contents of this document are protected by Copyright 2021 Autex Industries Ltd. All Rights Reserved. It is the user's responsibility to determine if the product and information presented in this document is suitable for the intended application by engaging a suitably qualified consultant. The information contained in this document is correct to the best of our knowledge at the date of its publication. To verify that this document is the most current publication please check our website or contact your Autex account manager.